

## TECHNICAL DATA SHEET

LFX IP20 / Xenon

VERSION - 06.07.2017

### STANDARD LUMINAIRE

Reference	LFX			
Protection Class	IP20			
Lighting Source	Xenon			
Connector	Rigid Loop on B'Light conductor 16mm <sup>2</sup>			
Dimensions	13 x 21mm			
Standard Length	330 - 670 - 1000 - 1330 - 1670 - 2000mm			
Length on measure	on request up to 3000mm			
Nb Lighting Unit	17 bulbs/m			
Voltage	24V			
Power	3W	5W	8.5W	10W
	51 W/m	85 W/m	144.5 W/m	170 W/m

### APPLICATION: cornices, handrails, stairs, shelves



#### LFX / Xenon - Rigid Loop

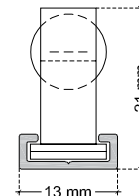

### FINISH

#### Color Finishing Profil

Standard	Natural Anodised Aluminium
On request	Thermo-Enameling Powder Coating RAL Color Anodising Polished Aluminium Chrome Aspect Polished Aluminium Old Gold Aspect

### ON REQUEST

Fixation	BFA (fixed with screw) FCP (fixed with screw) FCP-S (fixed with tape & screw)
Connecting Cable	COS3 - COS4 - COS4a
Connecting Plug	AF / AMS
Dimming Option	Phase 220V, Dali, KNX <i>Ask technical department for more information</i>

#### ON REQUEST: LFX Fixation



#### FCP-S (fixed with tape & screw)

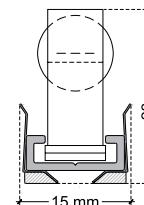

#### FCP (fixed with screw)

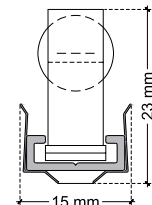

### LIGHTING SOURCE

Lighting Source	Xenon Long Life			
Glass	Clear or Frosted			
Power	3W	5W	8.5W	10W
Voltage	24V	24V	24V	24V
Beam Angle	360°	360°	360°	360°
Lifetime	20'000h	20'000h	10'000h	20'000h

#### Color Temperature & Luminous Flux / Unit

Power	3W	5W	8.5W	10W
CCT	2300K	2400K	2600K	2500K
Luminous Flux/Unit	12.6 lm	40 lm	95 lm	90 lm

#### ON REQUEST: LFX Fixation BFA

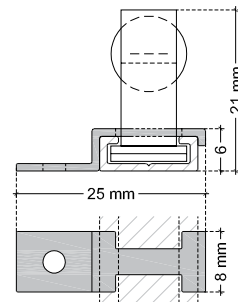

#### ON REQUEST : Connecting Cable

##### COS3 Power Connector



2x1m conductors of 2.5mm<sup>2</sup>

##### COS4 Linear bridging



2x8cm conductors of 2.5mm<sup>2</sup>

##### COS4a Corner bridging



1x8cm conductors of 2.5mm<sup>2</sup>  
1x11cm conductors of 2.5mm<sup>2</sup>

### CERTIFICAT



#### ON REQUEST : Connecting plug AF/AMS

