

## TECHNICAL DATA SHEET

### 4-PIN TRACK SYSTEM (=3 CIRCUITS)

VERSION - 08.09.2017

#### 4-PIN TRACK

Dimensions	35.2 x 35.5mm
Standard Length	1000mm, 2000mm, 3000mm, 4000mm cutable on measure
Shell Material	Aluminium Extrusion
Finish	White, Silver or Black
Protection Class	IP20



#### TECHNICAL DRAWINGS : 4-pin track

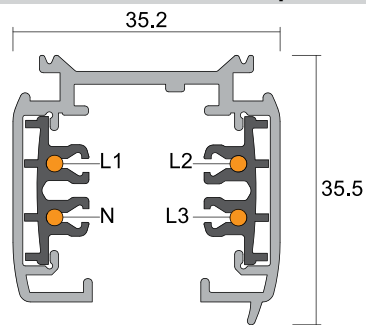

L=Track length				
L / mm	a / mm	b / mm	c / mm	d / mm
1000	120			
2000	120	863		
3000	120		909	2086
4000	120		1242	2753

REF	TRACK LENGTH	FINISH
EN-0410-W	1000 mm	White
EN-0410-S	1000 mm	Silver
EN-0410-B	1000 mm	Black
EN-0420-W	2000 mm	White
EN-0420-S	2000 mm	Silver
EN-0420-B	2000 mm	Black
EN-0430-W	3000 mm	White
EN-0430-S	3000 mm	Silver
EN-0430-B	3000 mm	Black
EN-0440-W	4000 mm	White
EN-0440-S	4000 mm	Silver
EN-0440-B	4000 mm	Black

## TECHNICAL DATA SHEET

### 4-PIN TRACK SYSTEM - ADAPTOR

VERSION - 08.09.2017

#### 4-PIN ADAPTOR

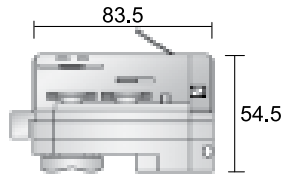

Dimensions	83.5 x Ht 54.5mm		
Ref	EN-0440-W	EN-0440-S	EN-0440-B
Finish	White	Silver	Black

#### 4-PIN ADAPTOR - ULTRA SLIM

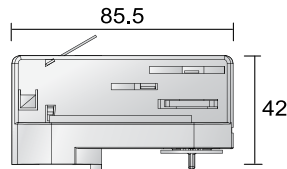

4-PIN adaptor is universal compatible.  
It will work with the following brand:

Dimensions	85.5 x Ht 42mm		
Ref	EN-0440S-W	EN-0440S-S	EN-0440S-B
Finish	White	Silver	Black

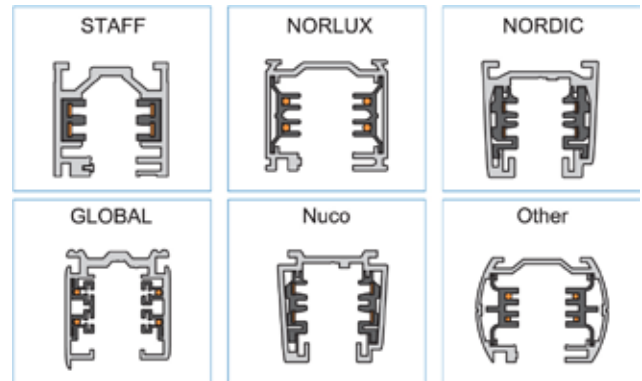

#### 4-PIN ADAPTOR - SMART

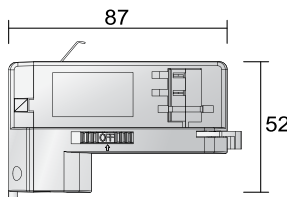

#### ONE PART ADAPT IT ALL :



Dimensions	87 x Ht 52mm		
Ref	EN-0490-W	EN-0490-S	EN-0490-B
Finish	White	Silver	Black

## TECHNICAL DATA SHEET

### 4-PIN TRACK SYSTEM - ACCESSORIES

VERSION - 12.09.2017

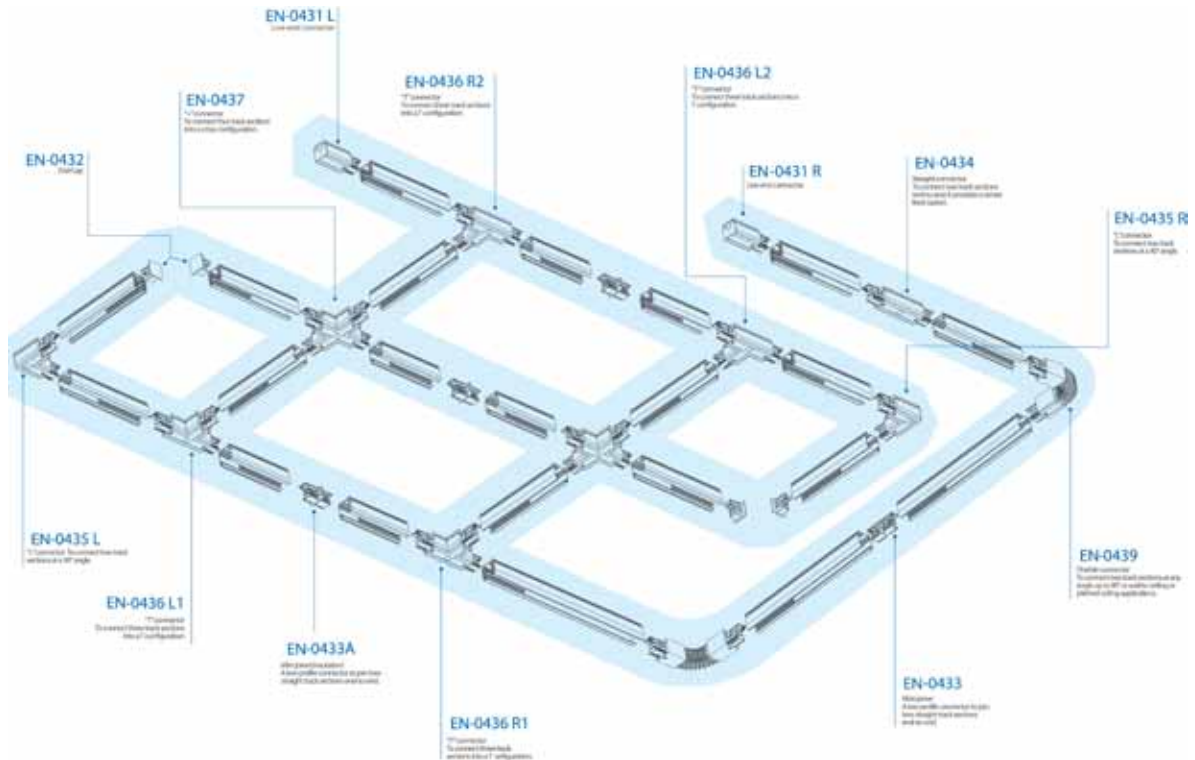

#### END CAP - To the track section end

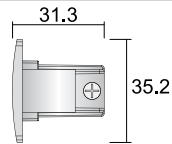

Dimensions	31.3 x 35.2mm		
Ref	EN-0432-W	EN-0432-S	EN-0432-B
Finish	White	Silver	Black

#### SUSPENSION CLAMP FOR TRACK CONNECTION

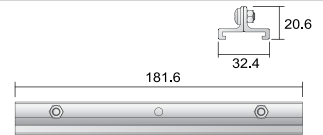

Dimensions	32.4 x 181.6 x Ht.20.5mm		
Ref	EN-04185K-W	EN-04185K-S	EN-04185K-B
Finish	White	Silver	Black

#### MINI JOINER - A low profile connector to joint 2 straight track sections end-to-end.

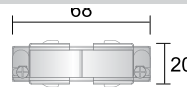

Dimensions	68 x 20mm		
Ref	EN-0433-W	EN-0433-S	EN-0433-B
Finish	White	Silver	Black

#### MINI JOINER - A low profile connector to joint 2 straight track sections end-to-end.

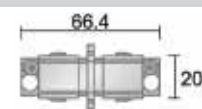

Dimensions	66.4 x 20mm		
Ref	EN-0433A-W	EN-0433A-S	EN-0433A-B
Finish	White	Silver	Black

#### SUSPENSION HOOK

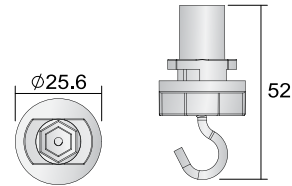

Dimensions	ø25.6 x Ht.52mm		
Ref	EN-M142-W	EN-M142-S	EN-M142-B
Finish	White	Silver	Black

## TECHNICAL DATA SHEET

### 4-PIN TRACK SYSTEM - CONNECTORS

VERSION - 12.09.2017

#### LIVE-END CONNECTOR

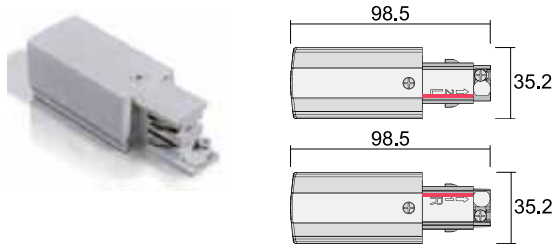

Dimensions	98.5 x 35.2mm		
Ref Left Polarity	EN-0431 L-W	EN-0431 L-S	EN-0431 L-B
Ref Right Polarity	EN-0431 R-W	EN-0431 R-S	EN-0431 R-B
Finish	White	Silver	Black

#### STRAIGHT CONNECTOR

To connect 2 track sections end-to-end. It provides a center feed option

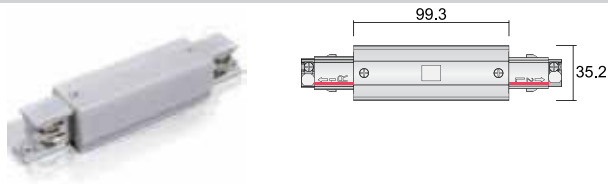

Dimensions	99.3 x 35.2mm		
Ref	EN-0434-W	EN-0434-S	EN-0434-B
Finish	White	Silver	Black

#### 'L' CONNECTOR

To connect 2 track sections at a 90° angle

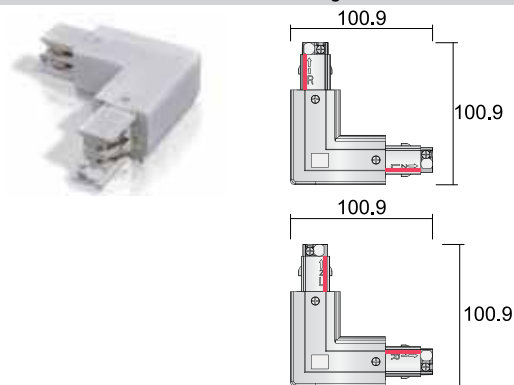

Dimensions	100.9 x 100.9mm		
Ref Left Polarity	EN-0435 L-W	EN-0435 L-S	EN-0435 L-B
Ref Right Polarity	EN-0435 R-W	EN-0435 R-S	EN-0435 R-B
Finish	White	Silver	Black

#### 'T' CONNECTOR

To connect 2 track sections into a T configuration

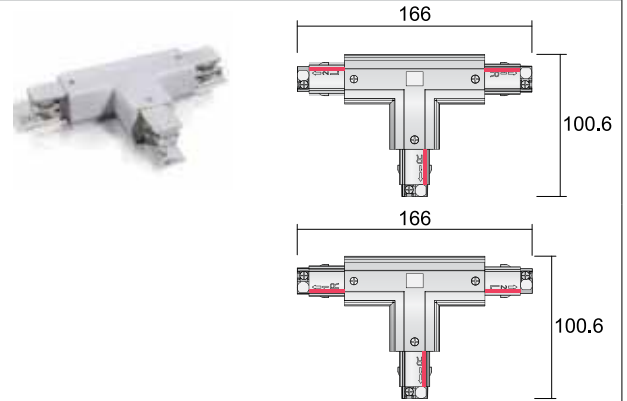

Dimensions	166 x 100.6mm		
Ref Polarity Left 1	EN-0436 L1-W	EN-0436 L1-S	EN-0436 L1-B
Ref Polarity Left 2	EN-0436 L2-W	EN-0436 L2-S	EN-0436 L2-B
Finish	White	Silver	Black

#### 'T' CONNECTOR

To connect 2 track sections into a T configuration

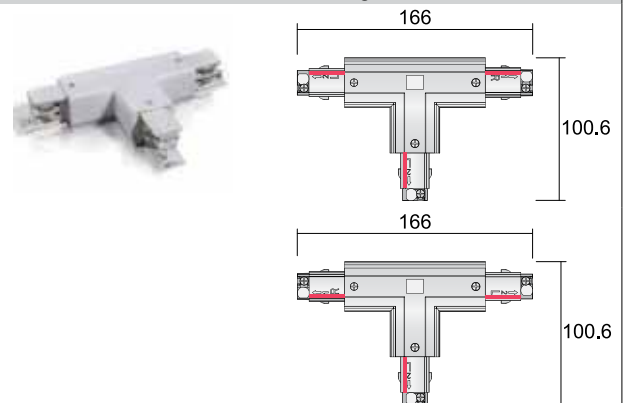

Dimensions	166 x 100.6mm		
Ref Polarity Right 1	EN-0436R1-W	EN-0436 R1-S	EN-0436 R1-B
Ref Polarity Right 2	EN-0436R2-W	EN-0436 R2-S	EN-0436 R2-B
Finish	White	Silver	Black

#### AGABEKOV



**AGABEKOV SA Manufacture** 6, ROUTE DE COMPOIS  
CH-1222 VÉSENAZ - GENEVA - SWITZERLAND  
Tel. +41 22 752 47 45 Fax. +41 22 752 37 08  
E-mail: info@aaabekov.com



**AGABEKOV SA Bureau d'etudes** 6, ROUTE DE COMPOIS  
CH-1222 VÉSENAZ - GENEVA - SWITZERLAND  
Tel. +41 22 752 47 45 Fax. +41 22 752 37 08  
Internet: www.aaabekov.com



## TECHNICAL DATA SHEET

### 4-PIN TRACK SYSTEM - CONNECTORS

VERSION - 12.09.2017

#### '+' CONNECTOR

To connect 4 track sections into a cross configuration

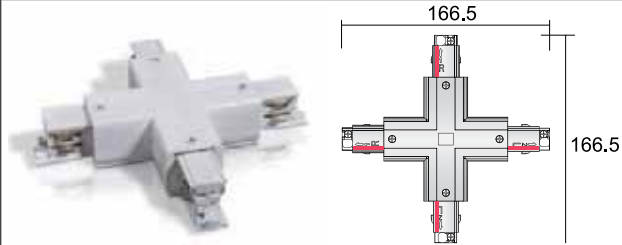

Dimensions	166.5 x 166.5mm		
Ref	EN-0437-W	EN-0437-S	EN-0437-B
Finish	White	Silver	Black

#### 'L' TWISTED CONNECTOR 1

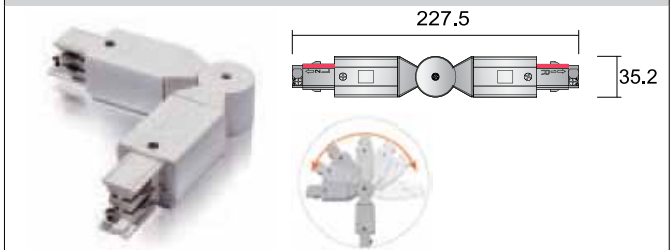

Dimensions	227.5 x 35.2mm		
Ref	EN-M435-W	EN-M435-S	EN-M435-B
Finish	White	Silver	Black

#### FLEXIBLE CONNECTOR

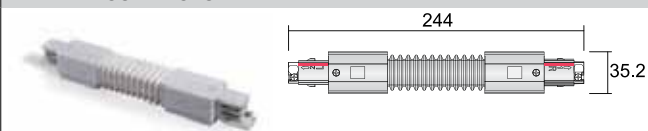

Dimensions	101 x 101mm		
Ref	EN-M438-W	EN-M438-S	EN-M438-B
Finish	White	Silver	Black

#### 'L' TWISTED CONNECTOR 2

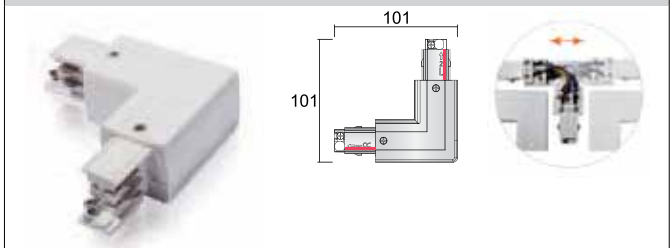

Dimensions	101 x 101mm		
Ref	EN-M438-W	EN-M438-S	EN-M438-B
Finish	White	Silver	Black

#### CONNECTION DIAGRAM EXEMPLE

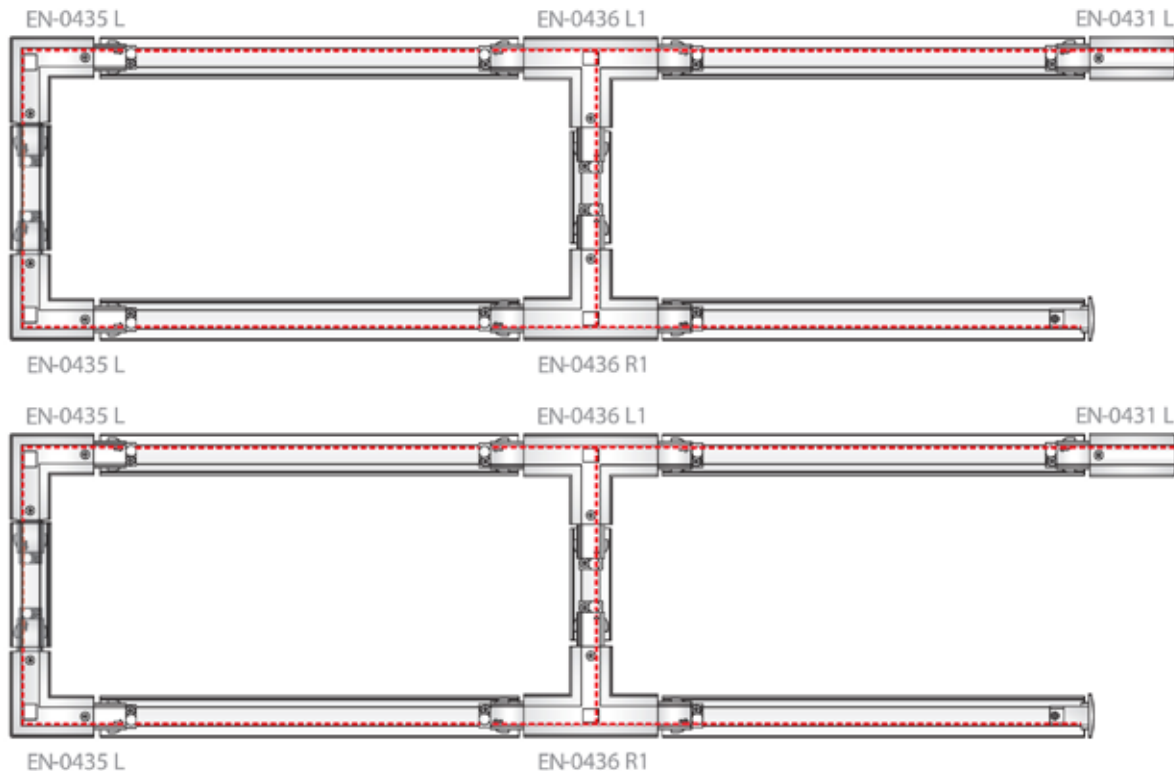

#### AGABEKOV



**AGABEKOV SA Manufacture** 6, ROUTE DE COMPOIS  
 CH-1222 VÉSENAZ - GENEVA - SWITZERLAND  
 Tel. +41 22 752 47 45 Fax. +41 22 752 37 08  
 E - mail: info@agabekov.com



**AGABEKOV SA Bureau d'etudes** 6, ROUTE DE COMPOIS  
 CH-1222 VÉSENAZ - GENEVA - SWITZERLAND  
 Tel. +41 22 752 47 45 Fax. +41 22 752 37 08  
 Internet: www.agabekov.com



## TECHNICAL DATA SHEET

### 4-PIN TRACK SYSTEM - CEILING MOUNTING

VERSION - 12.09.2017

#### CEILING MOUNTING KIT 1

Suspension kit with ROD

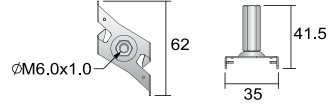

Dimensions	35 x 62 x Ht.41.5mm		
Ref	EN-EZ0447-W	EN-EZ0447-S	EN-EZ0447-B
Finish	White	Silver	Black

#### CEILING MOUNTING KIT 2

Suspension kit with wire

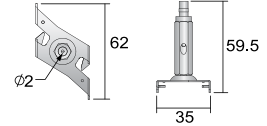

Dimensions	35 x 62 x Ht.59.5mm		
Ref	EN-EZ0448-W	EN-EZ0448-S	EN-EZ0448-B
Finish	White	Silver	Black

#### CEILING MOUNTING KIT 3

Reinforcement plate with suspension wire

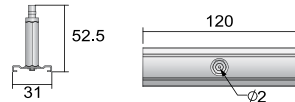

Dimensions	31 x 120 x Ht.52.5mm		
Ref	EN-M147-W	EN-M147-S	EN-M147-B
Finish	White	Silver	Black

#### CEILING MOUNTING KIT 4

Reinforcement plate with suspension rod

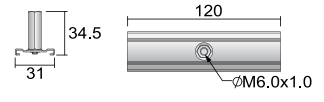

Dimensions	31 x 120 x Ht.34.5mm		
Ref	EN-M148-W	EN-M148-S	EN-M148-B
Finish	White	Silver	Black

#### Suspension Mounting Kits Manuel

1. Put the track into the kit parallellly

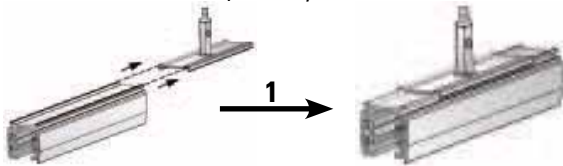

2. Release the start valve, press and get the wireope through the mounting kit

3. Rotate tight the start valve and lock the wireope.

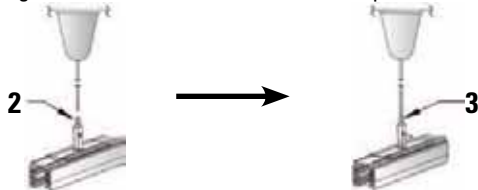

#### Suspension Mounting Kits Manuel

1. Put the track into the kit parallellly

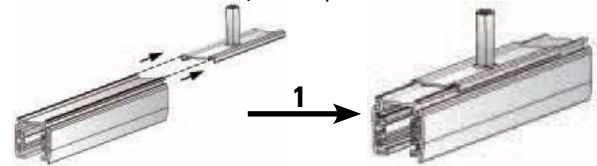

2. Rotate right the kit and fix it on the rod

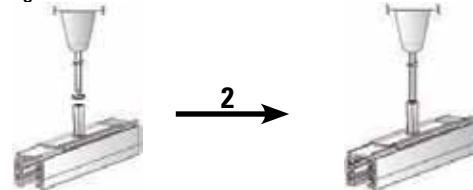

## TECHNICAL DATA SHEET

### 4-PIN TRACK SYSTEM - CEILING MOUNTING

VERSION - 12.09.2017

#### T-BAR MOUNTING KIT 1

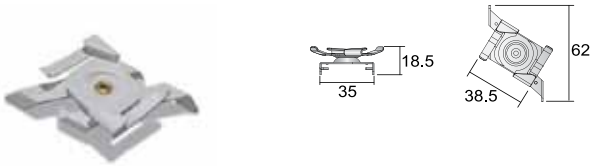

Dimensions	35 x 62 x Ht.18.5mm		
Ref	EN-M146T-W	EN-M146T-S	EN-M146T-B
Finish	White	Silver	Black

#### Suspension Mounting Kits Manuel

1. Adjust the mounting kit's direction, put it vertically into the T-Bar ceiling, and then rotate right and fix.



2. Adjust the mounting kit's direction, put the track vertically into the mounting kit, rotate left and fix.

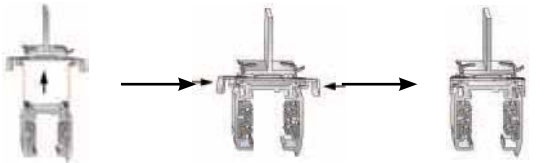

#### T-BAR MOUNTING KIT 2 with reinforcement plate

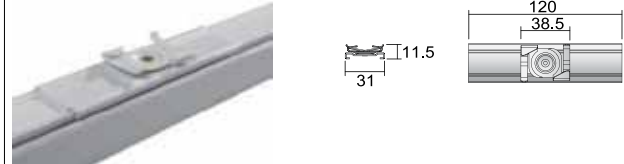

Dimensions	31 x 120 x Ht.11.5mm		
Ref	EN-M149-W	EN-M149-S	EN-M149-B
Finish	White	Silver	Black

#### Suspension Mounting Kits Manuel

1. Put the track into the mounting kits parallelly

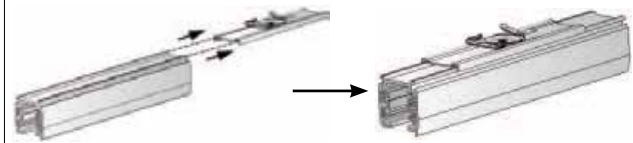

2. Adjust the mounting kit's direction, put the track vertically into the mounting kit, rotate right and fix.

